

How to use your MOVE UAntwerp-AP Application?

Table of contents

Purchasing MOVE subscription.....	2
Booking a sportsactivity	3
Cancelling a sportsactivity	4
How do I get acces/discount with a sportspartner?	5
What are my subscription benefits?	6
Notifications	7
Succes, your account is locked to this device.....	7
My profile	8
Contacts	9

1. Open the '**MOVE UAntwerpen-AP App**'
2. **Purchase** your MOVE **subscription**.
Do you already have a subscription? Go to step 3.

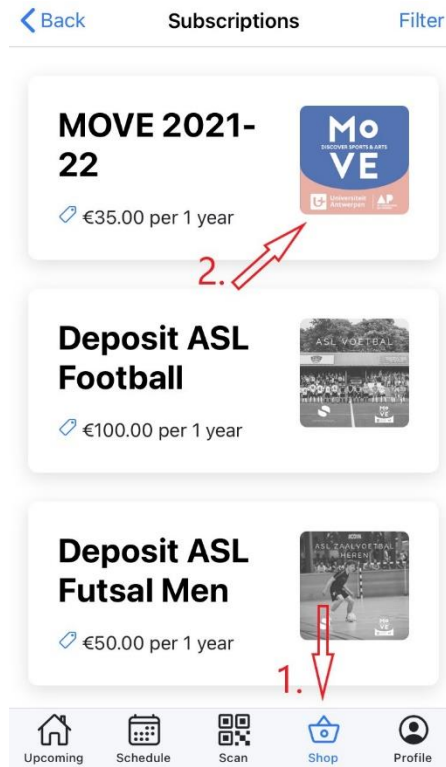

3. To **book** a **sportsactivity**

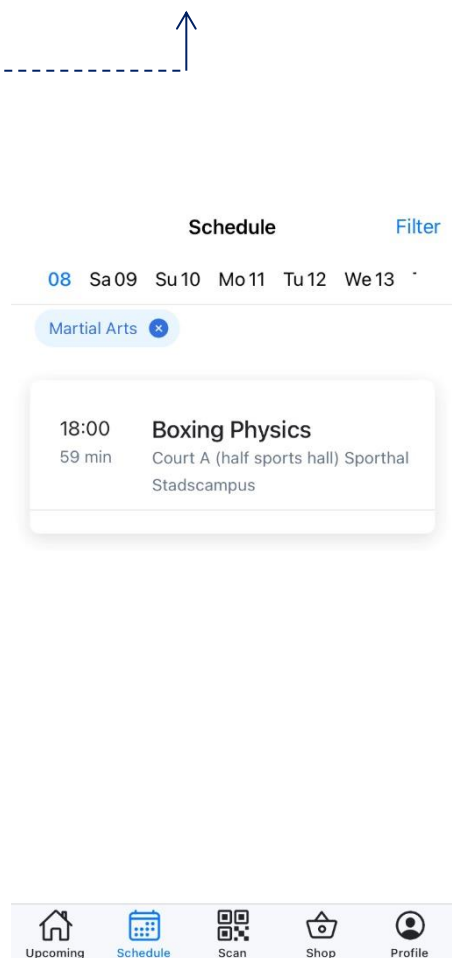
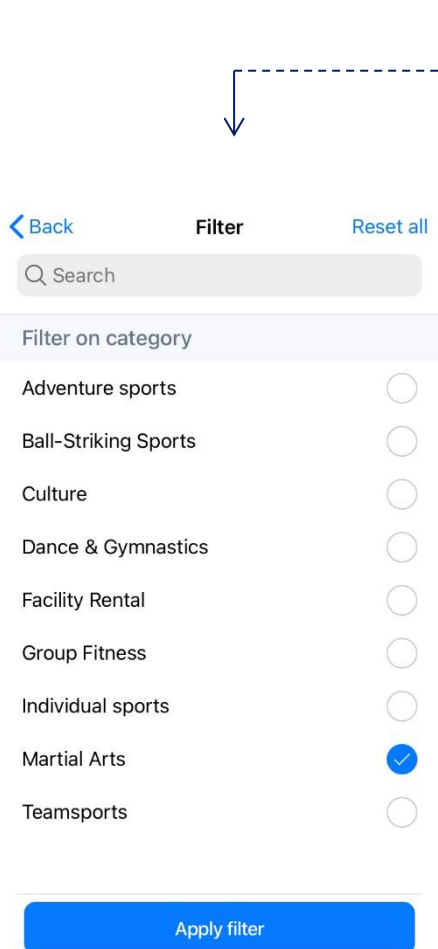
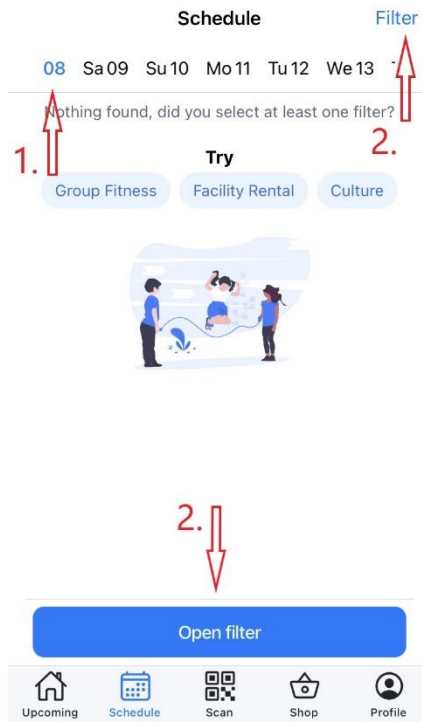
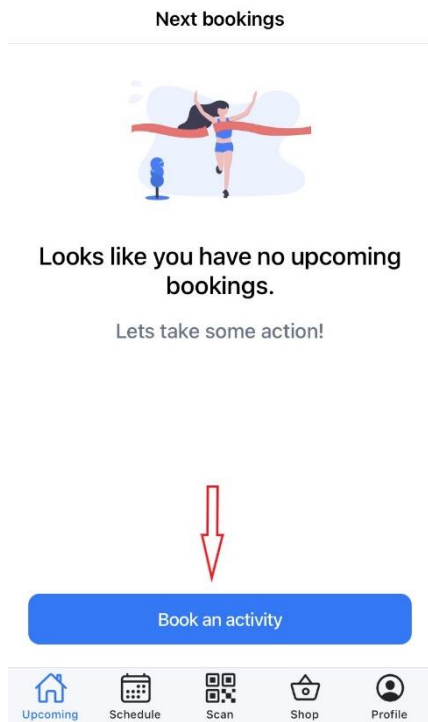

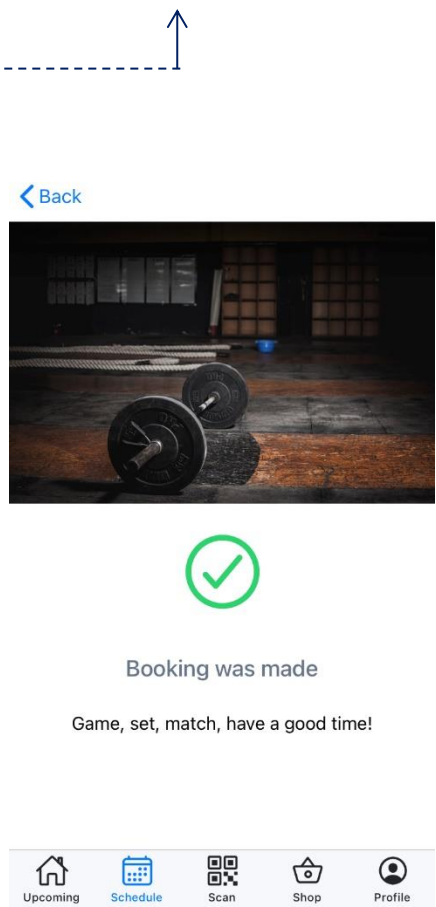
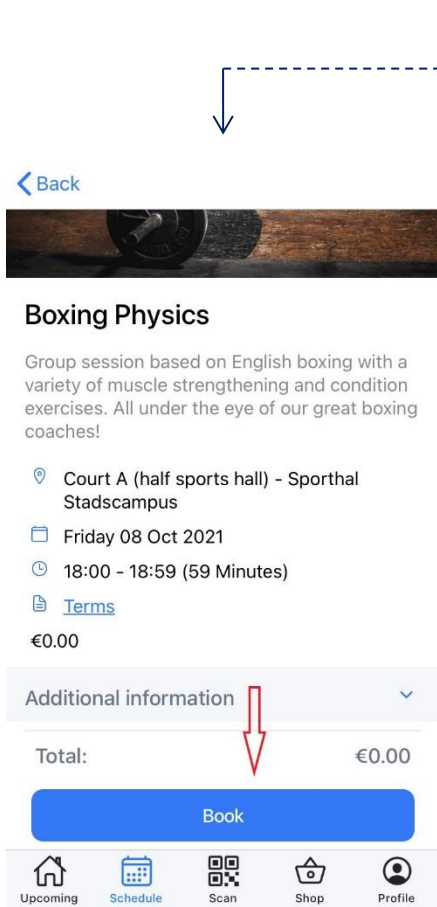

4. To **cancel** a sportsactivity

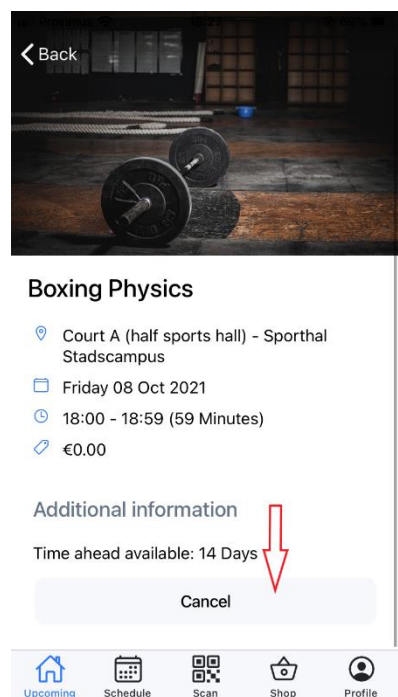
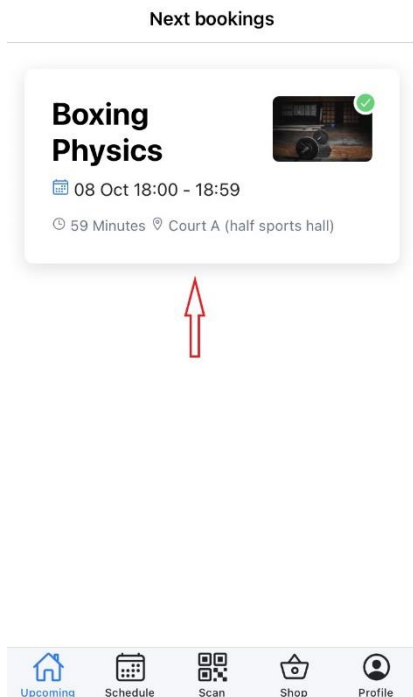

5. Scan to gain **access/discount** at a **sports partner**. The sports employee will show you a **QR code** that you need to scan. Once your screen turns **green** then the employee knows you have a **valid MOVE**.

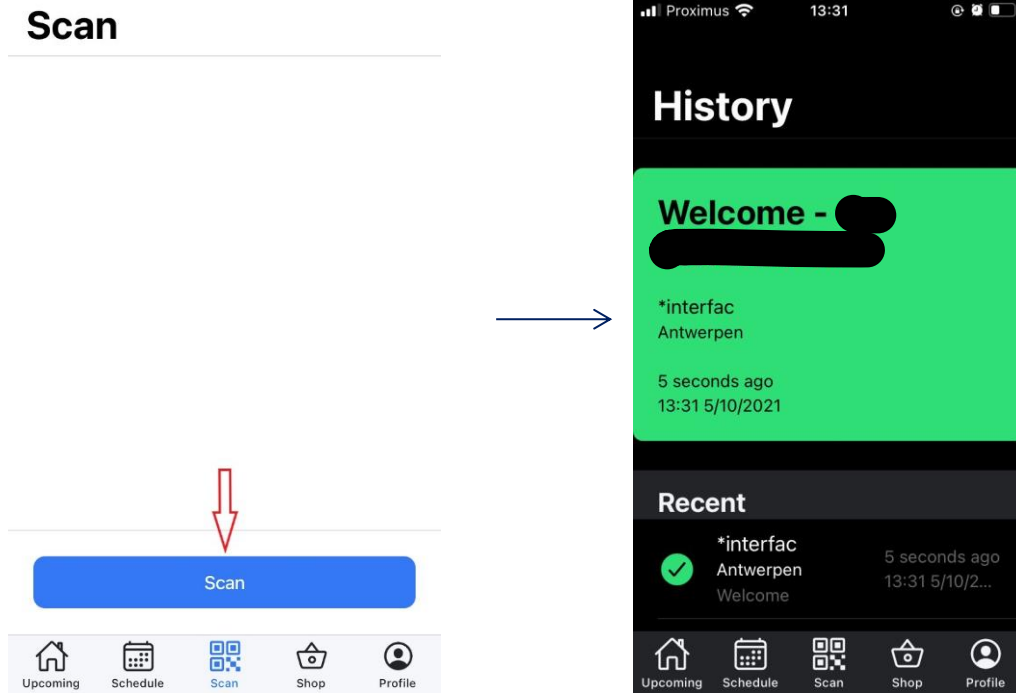

Is your screen **coloring red**? Please send an email to sport@uantwerpen.be or contact us by phone.

6. Personal data

- a. **Subscription benefits** can be seen at 'Subscription Overview'.

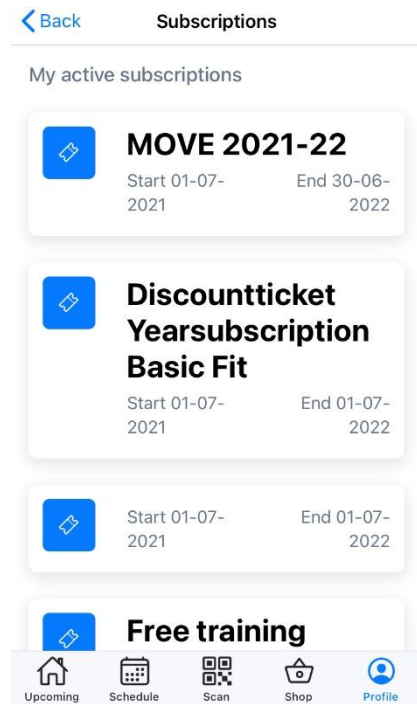
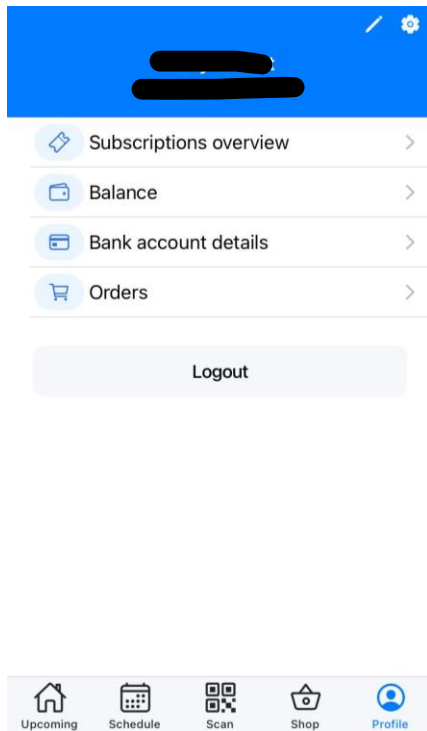

b. Notifications - Device locked

- i. You need to turn on '**Notifications**' if you want to get your confirmation e-mail, news, lesson changes and more.
- ii. '**Succes, your account is locked to this device until ...**': I.e. your MOVE account is connected to your smartphone. To prevent fraud, your account is linked to the smartphone you signed up with. Green box : Everything is OK.

Is the **box** colored **red**? Then click on 'Request device lock release'. If you have problems, contact sport@uantwerpen.be.

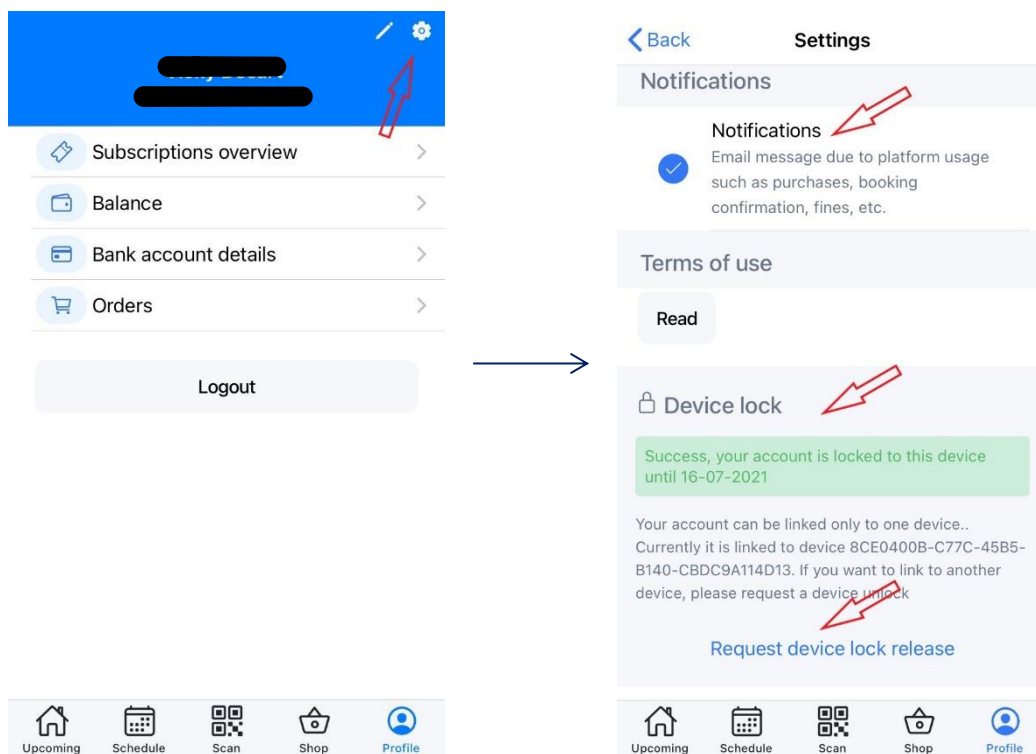

c. Profile

- i. Edit profile - Here you can edit personal information. To change your password:
 - i. Go to <https://uantwerpen.delcom.nl/pages/login>
 - ii. Click on 'My profile'
 - iii. Click on 'Password' and change your password.

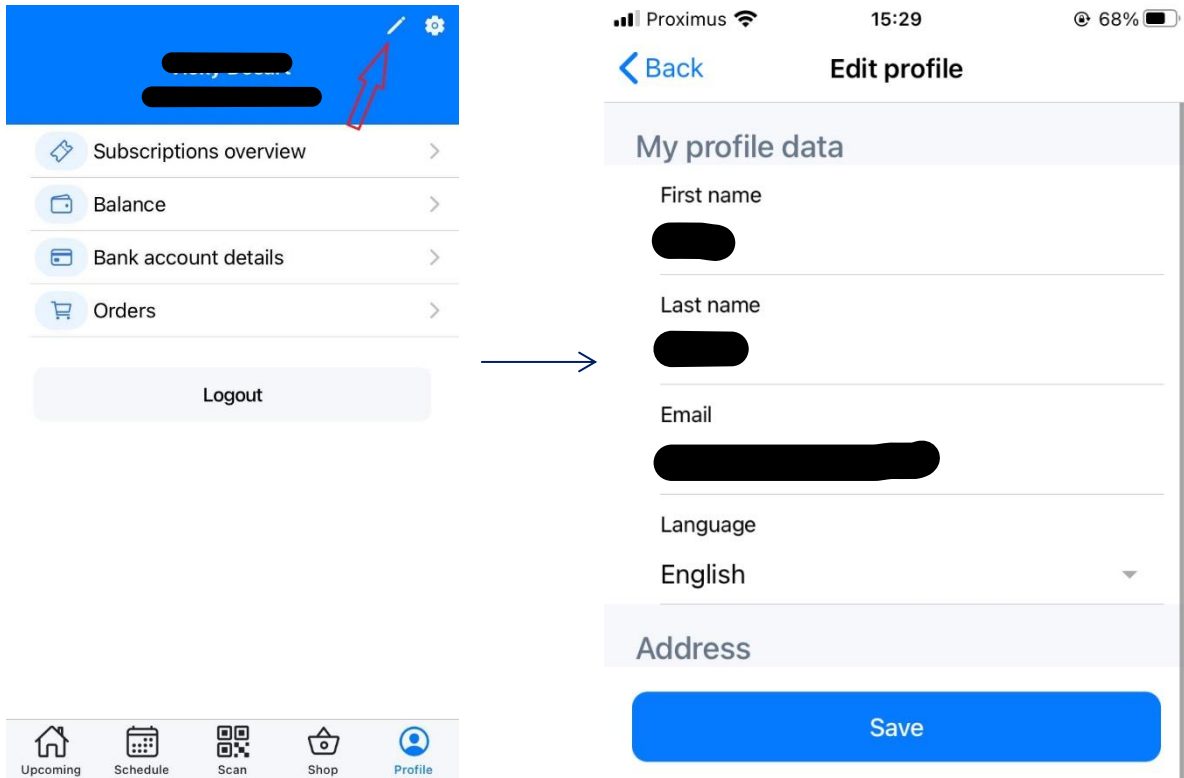

7. Contacts

Do you have a question? Then **email** us at sport@uantwerpen.be.

You can reach us **by phone** at: +32 (0)3 265 37 51.

Opening hours

Monday until Friday from 8.30 a.m. – 4.30 p.m.

Address

University of Antwerp Sports Office
Campus Middelheim, Building B
Middelheimlaan 1, B-2020 Antwerp

For more information, please visit the website <http://www.sportuantwerpen.be/en/>.